



MASTERK

THE MASTERS OF INDUSTRIAL WEIGHING

萬特佳

PERFECT FT3 WEIGHBRIDGE

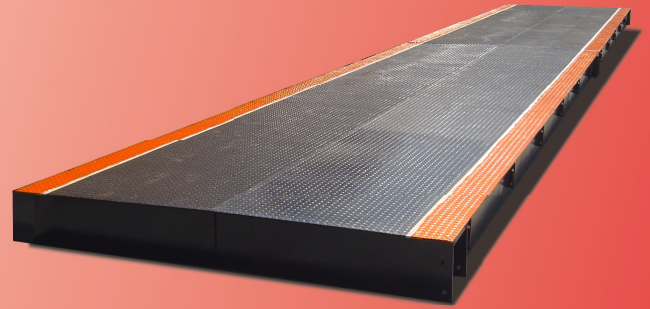

Characteristics

- ➔ - Modular metal frame
- Nominal load capacity: 50 tonnes (other possible).
- Standard width = 3 metres (other possible)
- Standard lengths: 9, 12 metres (6 load cells) & 14, 16 and 18 metres (8 load cells) (Specific dimensions: contact us).
- Overall height = 40 cm approx.
- For assembly & calibration on-site
- Weighbridge stabilized by 2 stops (lateral and longitudinal)
- Digital load cell

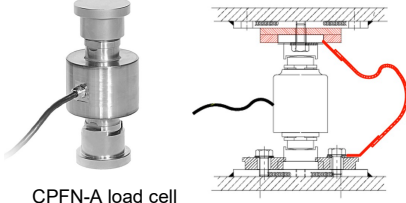

CPFN-A load cell

- Stainless steel load cells 30 tonnes each, sealed to IP68, with ARPEGE MASTER K digital technology.
- Load cells triple-protected against electrical hazards and lightning (internal electronic protective devices + transient suppressors in the junction box + insulation plates and earth braids)
- Load cell cables protected by rodent-proof envelop

➔ Pit / Pitless Version

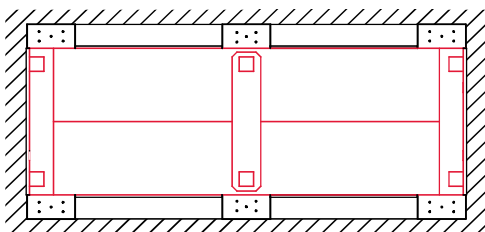

Pit Foundation (Typical)

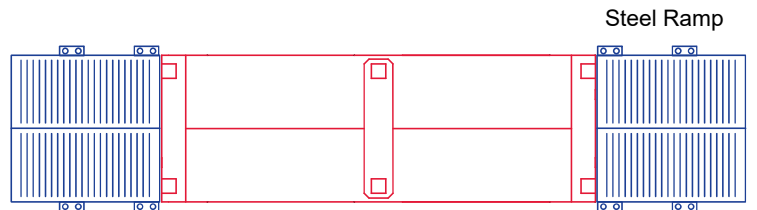

Pitless Foundation (Concrete / Steel Ramp)

THE MASTERS OF INDUSTRIAL WEIGHING





MASTERK

THE MASTERS OF INDUSTRIAL WEIGHING

萬特佳

Plan / Size

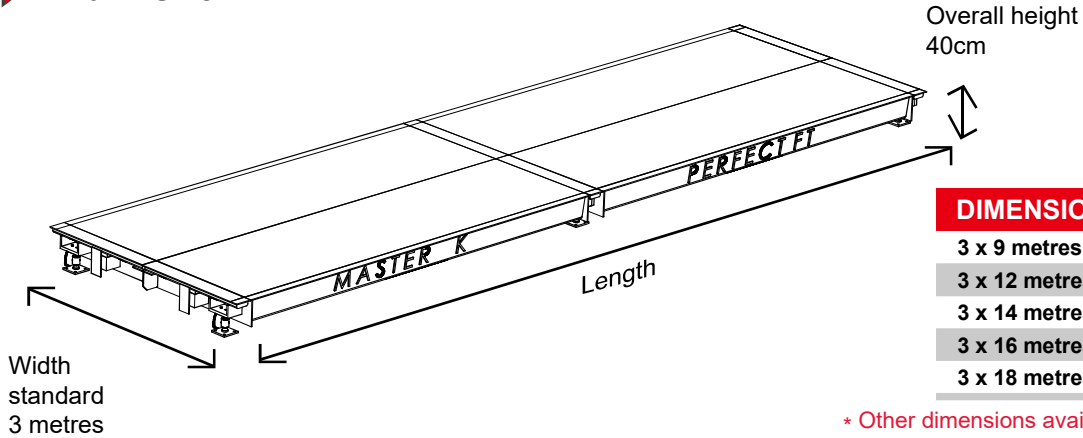

DIMENSIONS

- 3 x 9 metres (6 load cells)
- 3 x 12 metres (6 load cells)
- 3 x 14 metres (8 load cells)
- 3 x 16 metres (8 load cells)
- 3 x 18 metres (8 load cells)

* Other dimensions available on request

Options/Accessories

Side rails (Wheel guides)



Paint finish (2 coats of paint, 120 microns) or sand blasting (optionally available).

Steel ramps - standard 3 x 4 metres (other possible)



THE MASTERS OF INDUSTRIAL WEIGHING

