



ARPEGE MASTER^K

LES MAÎTRES DU PESAGE INDUSTRIEL



MULTI-SCALE WEIGHING CONTROLLER

IDé 500-I



Industry software

The new **IDé 500-I** controller allows the acquisition, the display and the transmission of the weight of 1 to 12 scales. It constitutes an innovative and performant solution to pour integrate the « weight » criteria in the PLC networks (Level surveillance, batching, weight control, ...)

- ➔ Compatible with all the strain gage load cells.
- ➔ 2 asynchronous serial links :
 - ➔ An RS232 and/or RS485 2 wires serial link (Short distance link : 10 meters maximum)
 - ➔ A passive current loop link, or in option RS232, RS485, Active or passive current loop (Long distance link)
- ➔ Simple and intuitive operator interface.
 - ➔ Graphic display with backlight, very good visibility.
 - ➔ 4 metrological keys.
 - ➔ 4 application keys.
- ➔ The IDé 500-I controller could be equipped with a field bus board to insure a secured data exchange at high speed with all type of PLCs :
 - ➔ MODBUS+ field bus board,
 - ➔ PROFIBUS DP field bus board,
 - ➔ DEVICE NET field bus board,
 - ➔ ETHERNET field bus board.
- ➔ Power supply also available in 12V or 24V DC in option.
- ➔ High reliability single board electronic.
- ➔ Digital conversational set up through the front panel.

LES MAÎTRES DU PESAGE INDUSTRIEL



Operation

The IDé 500-I equipped with the "INDUSTRY" software was conceived to supervise 1 to 12 measurement channels digitalized via a "CANDY-Ex" transmitter.

The IDé 500-I controller makes the weight acquisition of each "CANDY-Ex" transmitter 80 times per second through the CAN bus. It makes these information exploitable for a PLC device.

- Either through its RS485 asynchronous serial link, (JBUS/MODBUS protocol)
- Or, in option, by the intermediary of a field bus (MODBUS+, DEVICE NET, PROFIBUS DP, ETHERNET)

Each measurement channel is equipped with a "CANDY-Ex" transmitter which can supply and condition 1 to 8 load cells of an impedance of 400Ω (The minimum impedance for a "CANDY-Ex" is 50Ω)

Display

The IDé 500-I controller has an LCD graphic display which offers to the operator a great comfort in the system utilization.

The present weights with their states (Gross / Net, unit, zero correct, ...) for each scale are displayed in real time on the LCD screen.

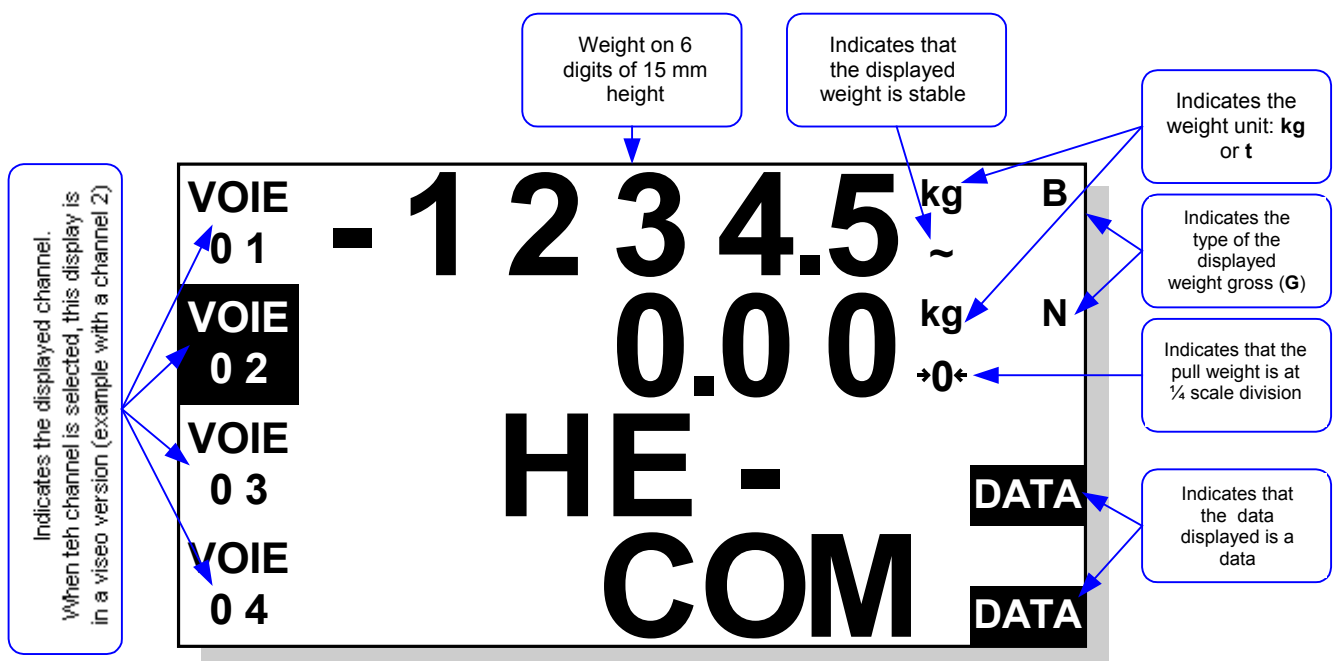

Example of a display with 4 channels

Block diagram

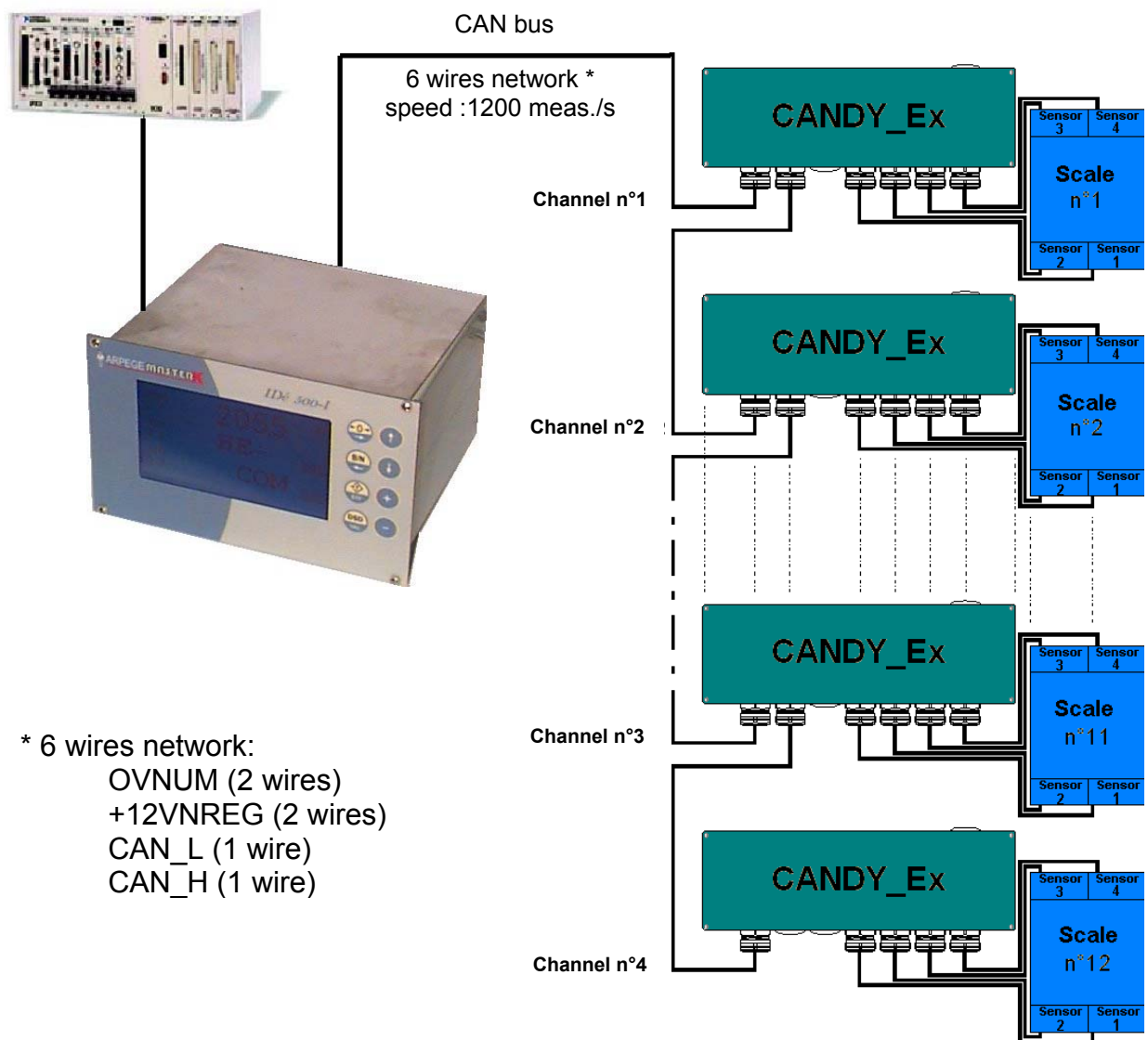

- * 6 wires network:
- OVNUM (2 wires)
 - +12VNREG (2 wires)
 - CAN_L (1 wire)
 - CAN_H (1 wire)

THE PERIPHERALS :

The IDé 500-I concentrator disposes in the standard version:

2 serial links :

COM1: RS232 and/or RS485 2 wires. (Short distance links : 10 meters max.)

COM2: Passive current loop, or in option RS232, RS485, passive or active current loop. (Long distance links)

* A special CAN interface type **MASTER CAN**

Communication with the "CANDY-Ex" and the weight remote displays. (Long distance links : 500 meters max.)

In option

- * 3 types of weight remote displays are available :
 - RP 15M : 15 mm weight remote display,
 - RP 75 : 75 mm weight remote display,
 - RP 125 : 125 mm weight remote display.

CHARACTERISTICS

Power supply Standard (Must be specified when ordering) Option	Mains 230 V 50Hz/60Hz + earth<5 ohms 12 VDC 24 VDC
Consumption EMC behavior	15 to 25 VA max depending of the configuration according to the standard EN 45 501
Load cell standard power supply Minimum load impedance for the Candy_Ex	5 V square wave signal 50 Ω or 8 load cells of 400 Ω in parallel
Operating temperature	-10/+40°C
Storage temperature	-20/+60°C
Real time clock drift	± 1 minute per month
Retention period of the data in the RAM memory	3 years backed up by a lithium battery
Graphic resolution of the LCD display	240*128 pixels
METROLOGICAL CHARACTERISTICS according to the standard EN 45 501	
Maximum number of scale divisions Internal resolution Sensitivity	6000 scale divisions 60 000 counts 0.5 μ V
Measurement rate	40 to 80 measurements per second
NOT LEGAL FOR TRADE CHARACTERISTICS	
Maximum weighing precision Internal resolution	10000 scale divisions 100000 counts

Space requirement

Front panel

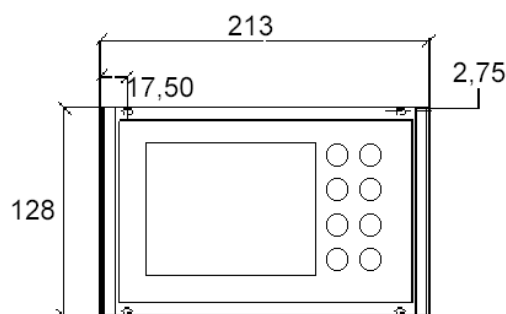

Panel cutout for an impacted mounting without frame

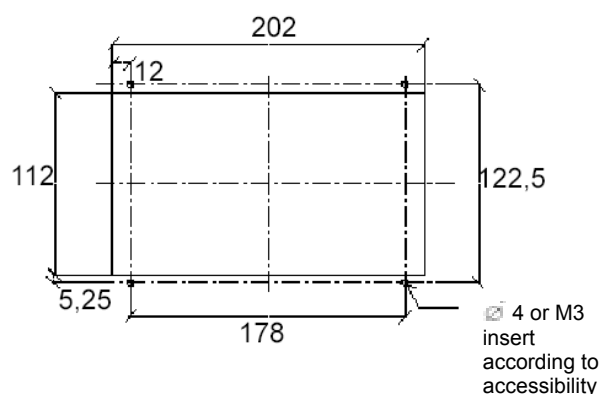

Profile view

